

# GLACIER LOFT 6-4

ADLER ARCHITECTS, INC.

210 N. HIGGINS AVE. - SUITE 334  
MISSOULA, MONTANA 59802  
(406) 549-4861

P.O. BOX 8521 • MISSOULA, MT 59807

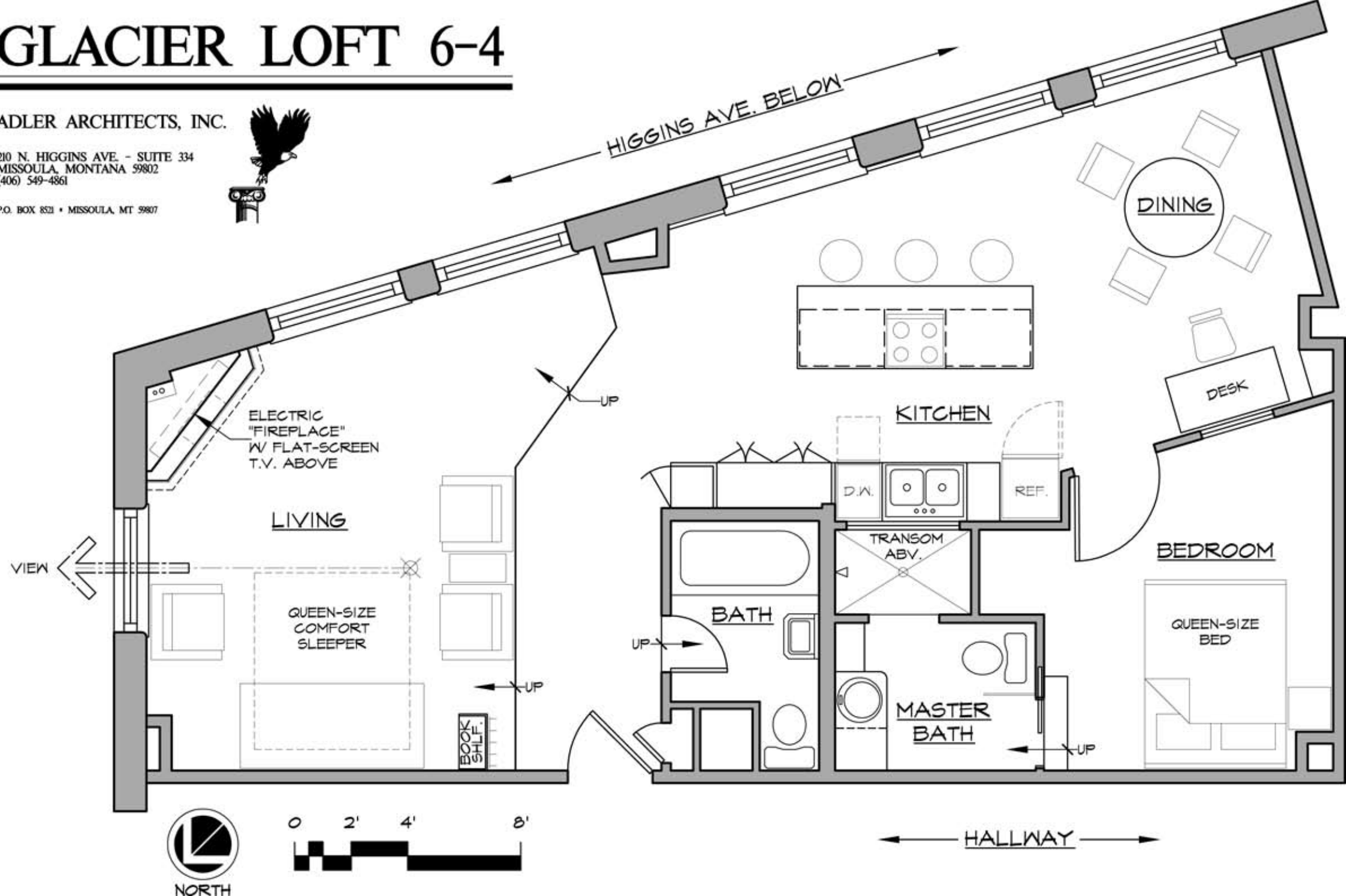

HIGGINS AVE. BELOW

DINING

ELECTRIC "FIREPLACE" W/ FLAT-SCREEN T.V. ABOVE

LIVING

QUEEN-SIZE COMFORT SLEEPER

BOOK SHLF.

KITCHEN

D.W.

REF.

TRANSOM ABV.

BATH

MASTER BATH

BEDROOM

QUEEN-SIZE BED

DESK

HALLWAY



NORTH

